

# REVELATION

by UTTERMOST

## ASSEMBLY INSTRUCTIONS

### R50231 - Door Console

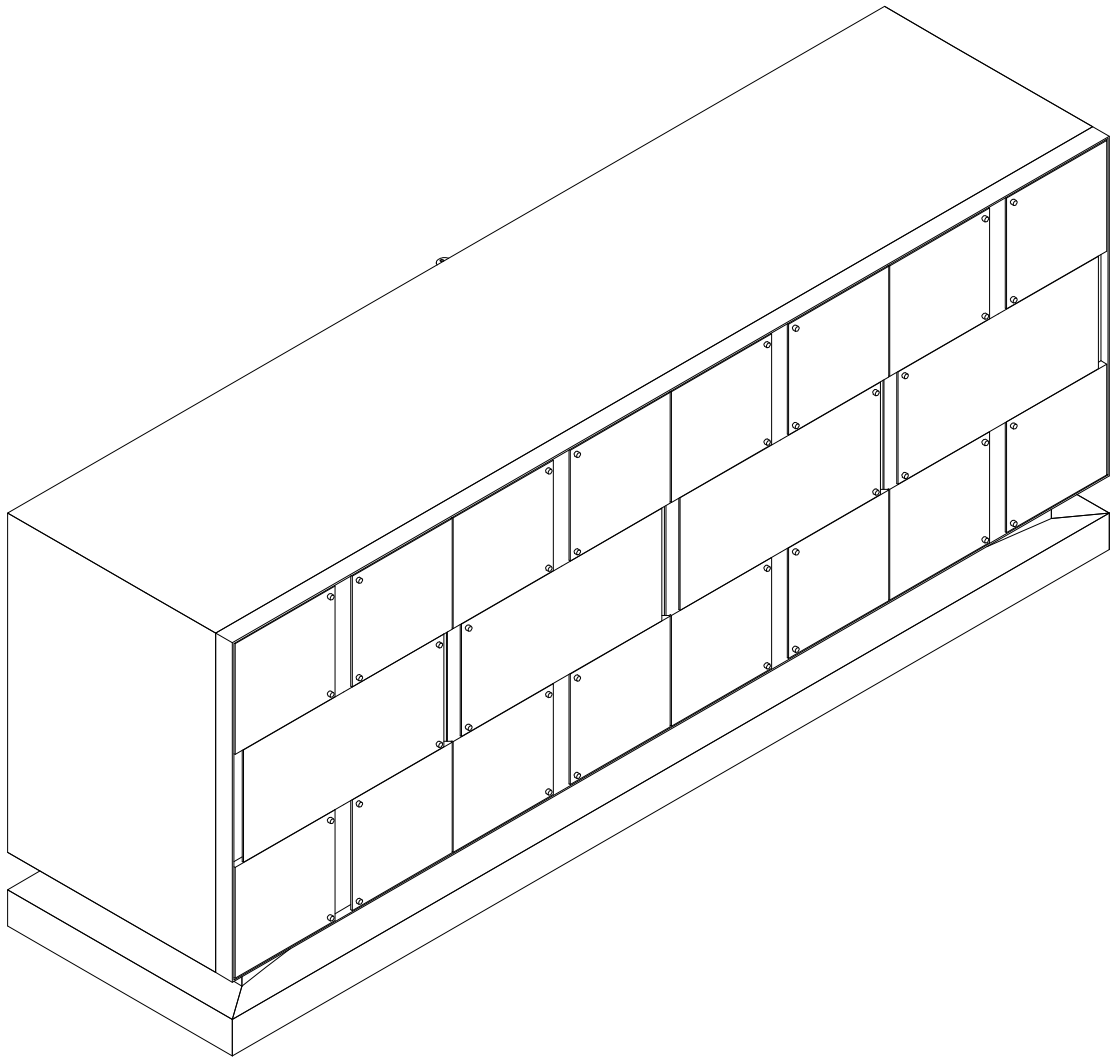

## PARTS LIST

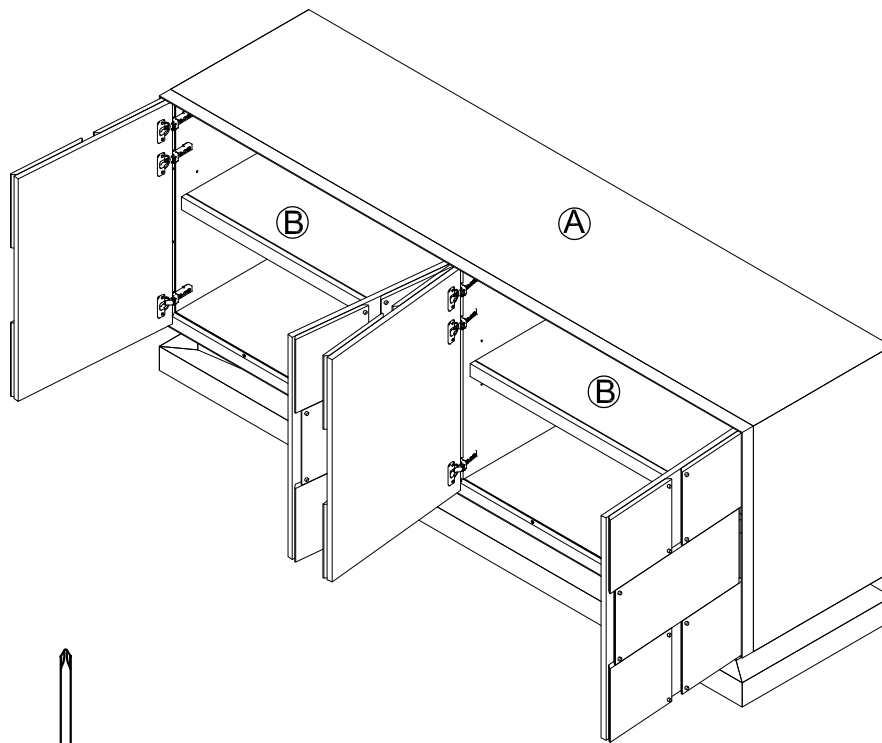

(K)

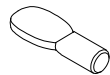

(J)



(I)



(H)



(G)

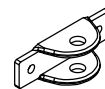

(F)

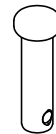

(E)



(D)



(C)

- |                           |                        |                                |
|---------------------------|------------------------|--------------------------------|
| (A) Cabinet (x1)          | (E) Clevis pin (x2)    | (I) Screw M4 x15 (x2)          |
| (B) Adjustable Shelf (x2) | (F) Bracket (x2)       | (J) Shelf pin (x8)             |
| (C) Metal cord (x1)       | (G) Wall plug (x2)     | (K) Screwdriver (Not included) |
| (D) Hair pin (x2)         | (H) Screw M5 x 40 (x2) |                                |

### IMPORTANT SAFETY INSTRUCTIONS

- Please read instructions carefully before assembling.
- Assembly requires at least two people.
- Use the above parts list to identify each component.
- Keep all packing materials until assembly is complete to avoid losing parts.
- Assemble on a soft level surface to avoid damaging item or floor.
- Recommend hand screwdrivers only for inserting screws—not power drills.

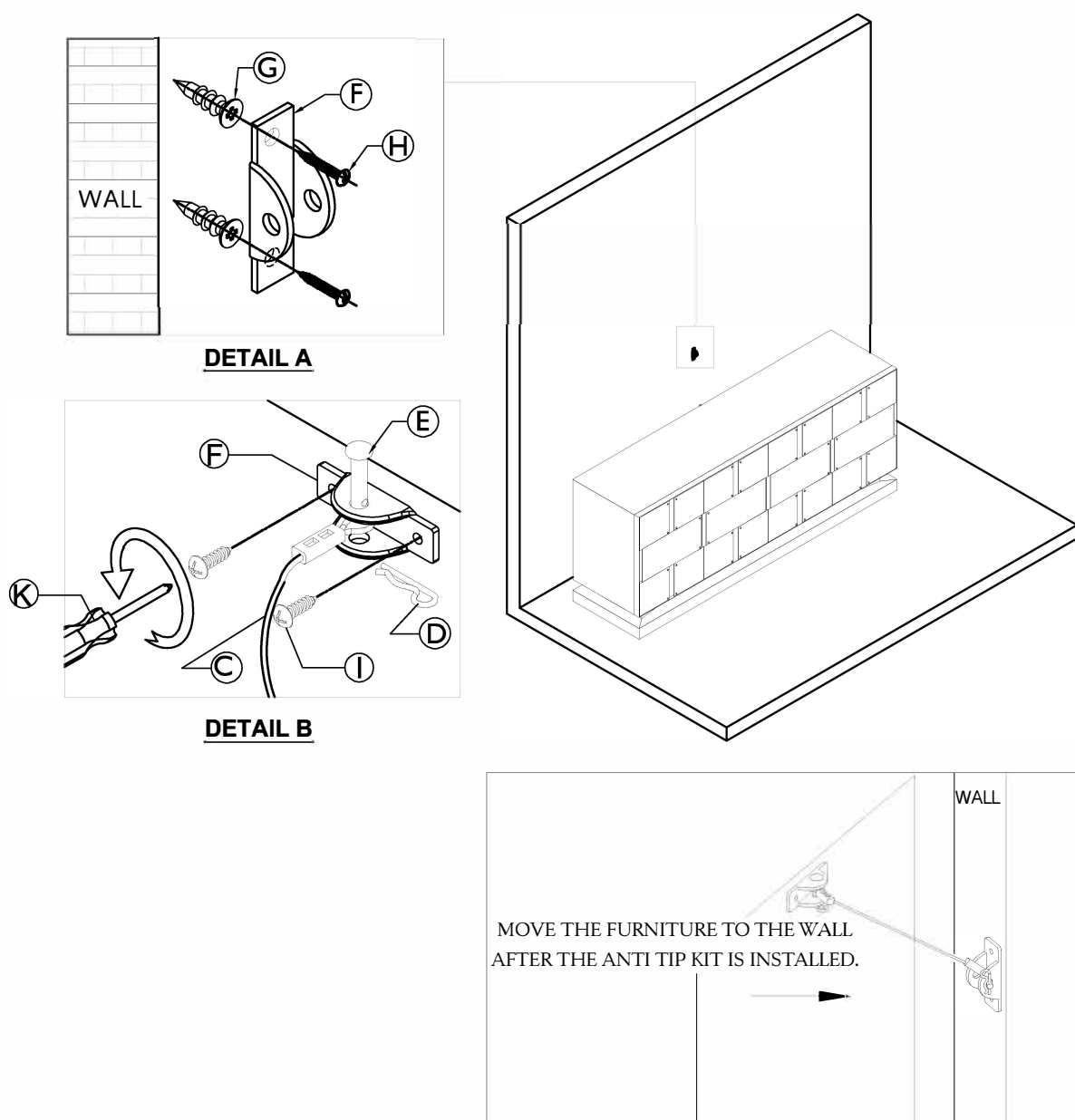

- . Unpack all parts and place them on a protected work surface.
- . Attach 1 metal bracket (F) near the middle-top back edge of the furniture piece by using shorter screws (I). (DETAIL B)
- . Determine the final position of the furniture piece. Position the metal bracket (F) on the wall stud approximately 2" below the metal bracket mounted to the back of the furniture. Mark and drill pilot hole into the center of stud with  $\frac{3}{32}$ " drill bit. Attach metal bracket (F) into the wall by using screws (H) and Wall plug (G). (Detail A)
- . Move the furniture into position with the brackets on the back edge in line with the brackets in the wall.
- . Insert the clevis pin (E) through holes on brackets and hole on metal cord (C).
- . Using hair pin (D) to go through small hole on clevis pin (E) to lock it. (Detail B)
- . Repeat above step to attach the end of metal cord (C) to the metal bracket on the wall. (DETAIL B)
- . Check to make sure the metal cord are securely laced and locked to the brackets.

- . Insert the Shelf pin (J) through holes side and backside of the cabinet. Place shelf (B) on shelf pin(J).
- . When the cabinet is installed in position, the levelers at the bottom of the feet may need adjusting to ensure the cabinet is level.

